



SHARLIGHT ELECTRONICS CO., LTD.

SPECIFICATION FOR APPROVAL

Part No. : SLE-190NW40-DC4

Package Dimensions

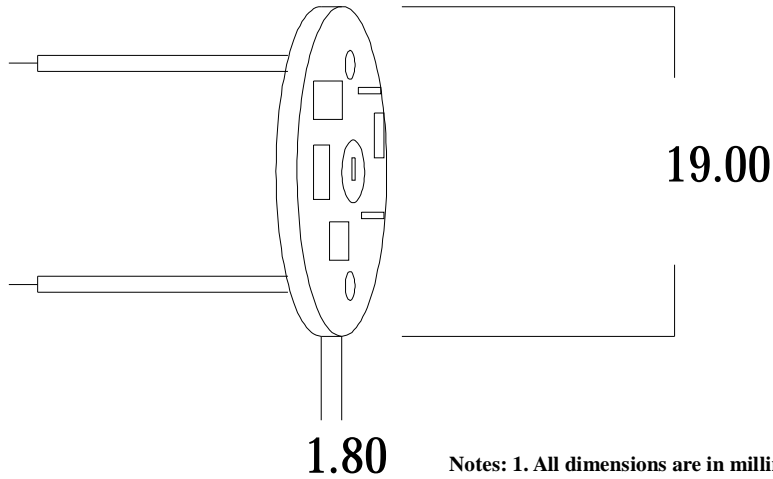

- Notes: 1. All dimensions are in millimeters (inches).
 2. Tolerance is $\pm 0.25\text{mm}(.010\text{'})$ unless otherwise noted.
 3. Protruded resin under flange is $1.0\text{mm}(.04\text{'})$ max.
 4. Lead spacing is measured where the leads emerge from the package.
 5. Specifications are subject to change without notice.

Absolute Maximum Ratings at TA=25°C

Electrical / Optical Characteristics at TA=25°C

Parameter	Maximum Rating	Unit
Power Dissipation	1	W
Peak Forward Current (1/10 Duty Cycle, 0.1ms Pulse Width)	400	mA
Continuous Forward Current	350	mA
Reverse Voltage	5	V
Operating Temperature Range	-40°C to +80°C	
Storage Temperature Range	-40°C to +80°C	
Lead Soldering Temperature [1.6mm(.063") From Body]	230°C for 5 Seconds	

Parameter	Symbol	Min.	Typ.	Max.	Unit	Test Condition
Luminous Intensity	IV	4	7	11	cd	IF = 350mA
Viewing Angle	$2\theta_{1/2}$		110		deg	IF = 350mA
Chromaticity Coordinates	X		0.3			IF = 350mA
	Y		0.3			
Forward Voltage	VF	4.3	4.5	4.7	V	IF = 350mA
Reverse Current	IR			100	μA	VR = 5V

TYPICAL ELECTRON-OPTICAL CHARACTERISTIC CURVES 25°C Free Air Temperature Unless Otherwise Specified

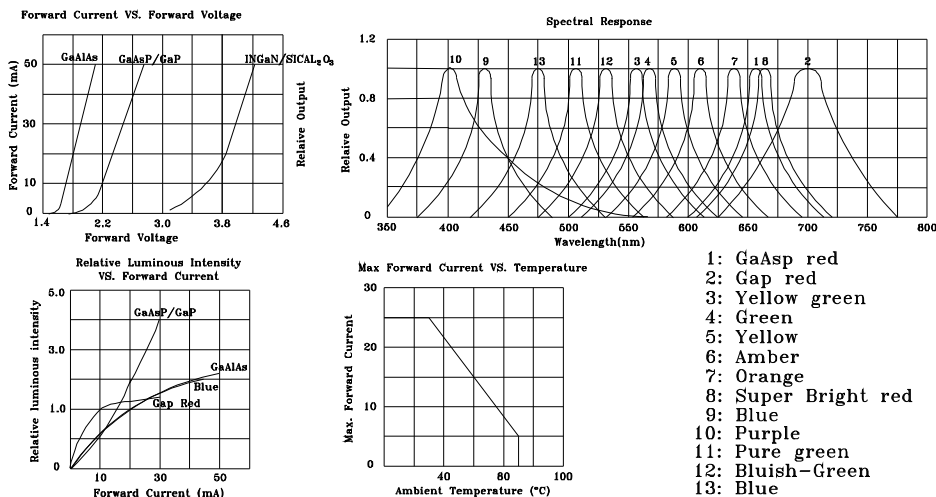

LISTER : 洪振益 04-30-04

EDITOR : 王重凱 04-30-04

DATE : 04-30-04

REV : 1